

S3

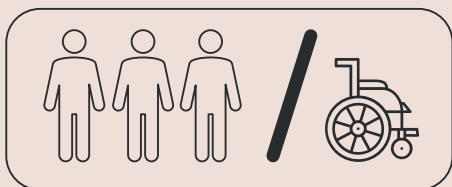

USER GUIDE

uplifts
BY STANNAH

Welcome to your new homelift.



We're delighted that you've chosen our homelift for your home. This guide will help you understand how to use it safely and effectively.

Let's get started.

Contents

1. Introduction	4
2. Important warnings	5
3. Getting started	6
4. Using your homelift	8
5. Safety features	12
6. Safety procedures	14
7. Maintenance and care	16
8. Troubleshooting	18
9. Technical data and declaration of conformity	20
10. Disposal and recycling	22
11. Contact us	23



1. Introduction

Our homelift is designed to provide you with the convenience and ease of moving between floors in your home. Whether you have mobility challenges or simply want to add a touch of luxury to your home our homelift is here to enhance your living experience.



2. Important warnings



Before using your homelift, please read and follow these important safety warnings.

- **Do not exceed the maximum weight limit** of 250kg/39 stone/551lbs.
- **Ensure proper maintenance:** ensure that the homelift is serviced annually by an approved professional.
- **Keep the area around the homelift clear** of obstructions.
- **Ensure children are supervised at all times:** when the homelift is in use, ensure that they cannot access the travel area. Do not allow young children to operate the homelift unsupervised.
- **Follow emergency procedures:** familiarise yourself with the homelift's emergency features and procedures in case of an emergency. Keep your emergency door release tool in a safe place near to the homelift.
- **Do not use your homelift if there is a fire.**
- **Do not attempt to open the door unless it is at a boarding position.**

3. Getting started

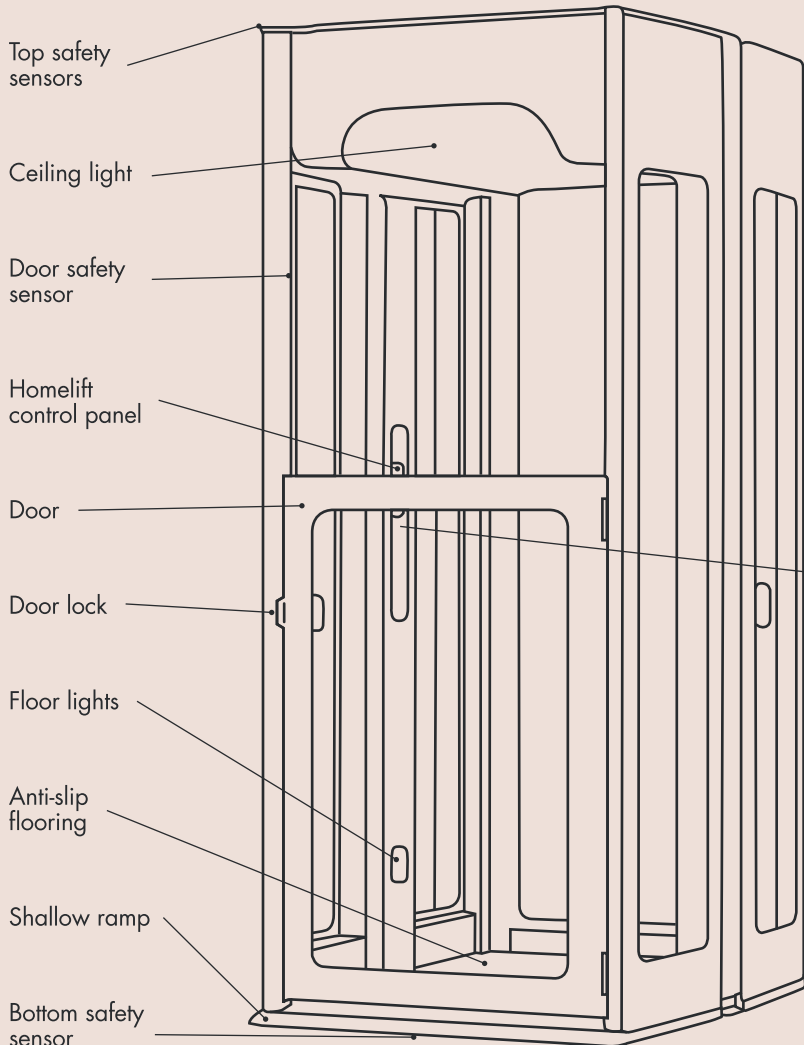

3. Getting started

Before your first ride, take a moment to familiarise yourself with the homelift's controls and safety features. Your installer will provide you with a demonstration and answer any questions that you have.

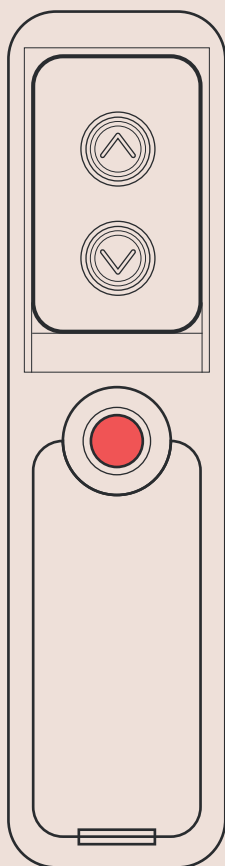

Control panel

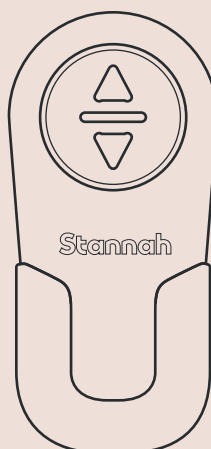

Wall controls

4. Using your homelift: step-by-step instructions

Going upstairs ▲

Step 1 - Calling the homelift.

If you need to call the homelift to you, press and hold the down button on the wall controls until the homelift has stopped on the ground floor.

Step 2 - Open the door by pulling it towards you.

Step 3 - Get into the homelift and close the door by pulling it towards you. Once in, keep clear of the door area to avoid activating the safety system around the opening (half-height door only).

Step 4 - To travel upstairs, press and hold the up-arrow button. You will need to push and hold the button until you arrive upstairs. If you release the button the homelift will stop. Keep pressing the up button, the homelift will stop automatically when it has arrived.

Step 5 - Push the door open and leave the homelift.

Step 6 - Always close the door after use.

The lights will turn off automatically after 2 minutes.

4. Using your homelift: step-by-step instructions

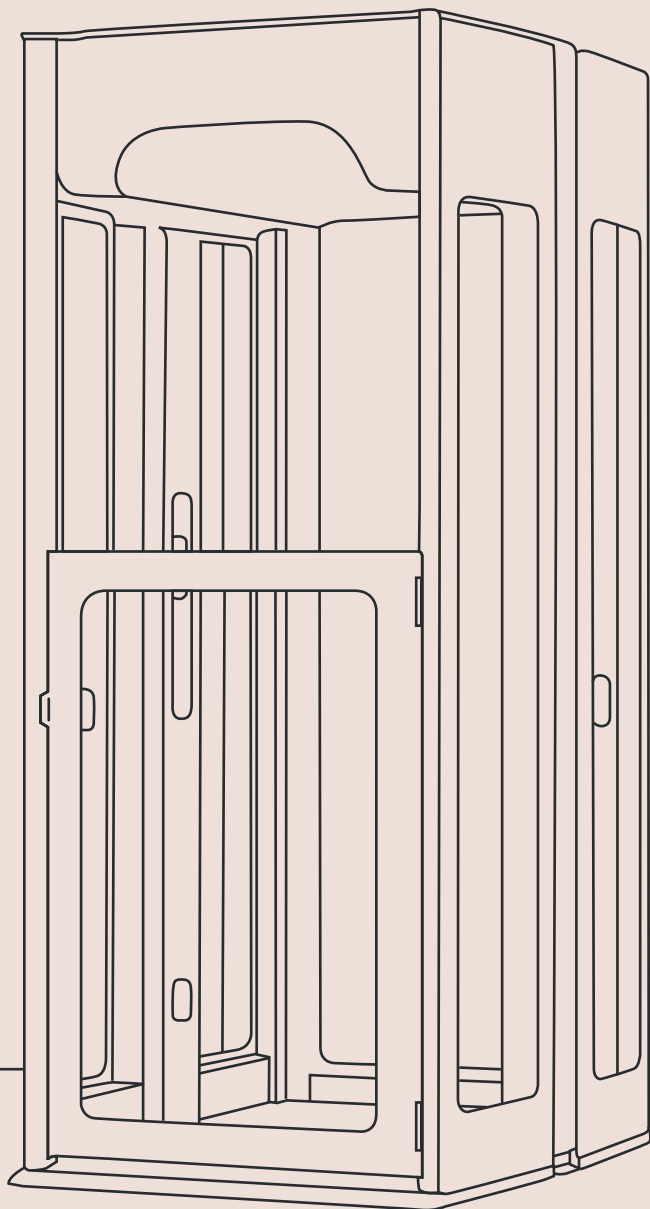

4. Using your homelift: step-by-step instructions

Going downstairs ▼

Step 1 - Calling the homelift.

If you need to call the homelift to you, press and hold the up button on the wall controls until the homelift has arrived and stopped automatically.

Step 2 - Open the door by pulling it towards you.

Step 3 - Get into the homelift and close the door by pulling it towards you. Once in, keep clear of the door area to avoid activating the safety system around the opening (half-height door only).

Step 4 - To travel downstairs, press and hold the down-arrow button. You will need to press and hold the button until you arrive downstairs. If you release the button the homelift will stop. Keep pressing the down button, the homelift will stop automatically when it has arrived.

Step 5 - Push the door open and leave the homelift.

Step 6 - Always close the door after use.

The lights will turn off automatically after 2 minutes.

4. Using your homelift: step-by-step instructions

Options

Folding seat.

Seat can be lifted to fold and pulled down to use.

Max load = 120 kg.

Bench seat.

Can be lifted out of position when not required.

5. Safety features

Your homelift is equipped with several safety features to ensure your wellbeing.

Emergency stop button.

Located in the centre of the control panel, this red button will immediately stop the homelift when pressed. To reset the button, turn the button in the direction shown on the button. You will now be able to use the homelift again. If this has not been reset then a general alert will be shown on the control panel.

Safety sensors.

Safety sensors are fitted at the top and bottom of your homelift and around the door opening (half-height door only).

These will stop the homelift if any obstructions are detected.

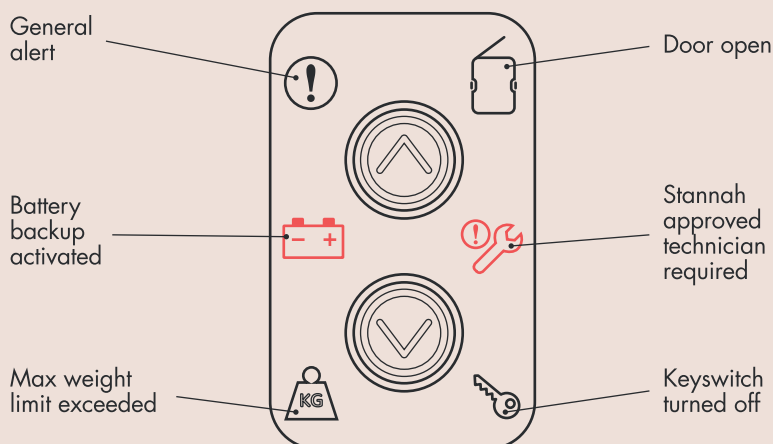

5. Safety features

Door open.

Check that the door is shut properly.

General alert.

Safety sensor have been activated. Ensure your hands are inside the homelift. If the light is still on then it may be one of the upper or lower safety edges. To resolve this, travel back in the direction that you have come from and ensure that all areas in the travel path of the homelift are clear. If this does not resolve the issue then check whether the emergency stop button has been activated and reset if necessary.

Max weight limit - 250 kg exceeded.

Although this alert only activates when going upstairs it is important that the homelift is not overloaded when coming downstairs to avoid damaging your homelift.

Stannah approved technician required.

Call your customer service team to make an appointment.

Key.

Child lock activated: the homelift will not travel until the key has been switched to the on position.

Battery backup activated.

Caution: if there is a power cut you can travel downstairs once but not back upstairs. If there is power in the home, check that the powerpoint has not been turned off (if it is accessible). If the powerpoint is on or not accessible call your Stannah approved technician.

6. Safety procedures

Using the homelift in a power cut.

The homelift is fitted with a battery backup which will allow you to complete your journey downstairs. You should not use your homelift again until the power has been restored.

Activating the emergency stop button.

In the very unlikely event that the homelift does not stop when you release the control button, press the red stop button. To reset the button turn it in the direction indicated on the button.

Emergency door release.

If you have arrived at the top or bottom but the door has failed to open, we have provided an emergency door release tool which can be used to open the door from the outside. This will need to be done by someone else in the home. This tool should be kept somewhere safe and easily accessible. Before you use the homelift again, call your Stannah approved technician to inspect the homelift.

Emergency communication system.

If there is no one that can assist you in the house, we have provided an emergency communication system to call for help. In an extremely unlikely event that your homelift stops whilst you are using it, try to travel back in the direction that you have come from. If this does not help, then use the emergency communication system to call for assistance. You will find the device below the control panel behind a cover. Remove the cover and press the call button.

6. Safety procedures

The unit will call your pre-programmed emergency numbers chosen by you at the time of installation. It will call the numbers in order, and you will use the built-in microphone and speaker to communicate. The microphone is very sensitive, so you do not need to bend down or remove the unit to be heard. If your emergency numbers change, then please tell your service centre and they will update them.

If there is a fire.

As with all lifts it is not recommended to use your homelift to evacuate in a fire. The communication system can still be used to call for help.

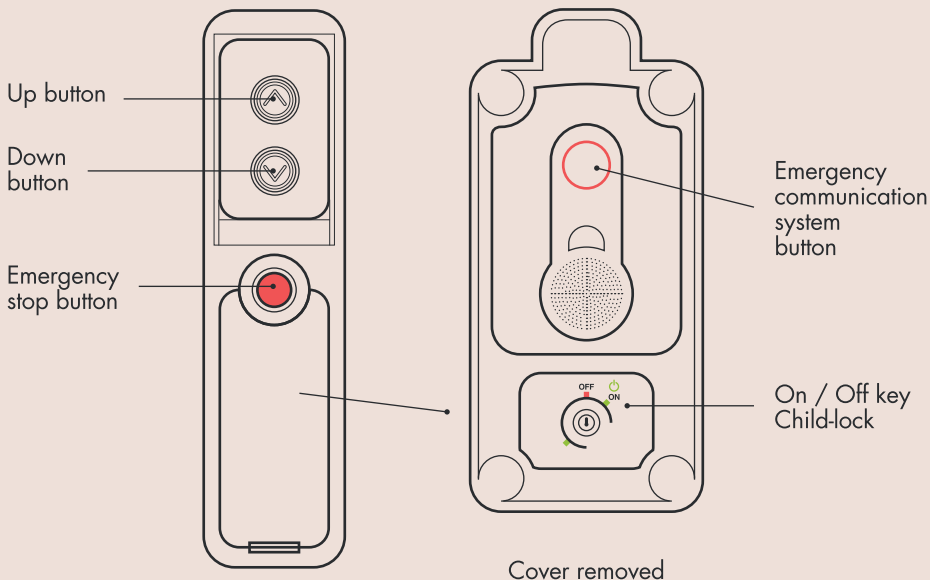

7. Maintenance and care

Important recommendations for looking after your homelift.

- **Service your homelift annually** by a Stannah approved technician to ensure that it continues to operate reliably.
- **Only use the homelift for its intended purposes**, as it should not be used for transporting heavy goods which may exceed the weight limit of 250 kg and result in damaging the homelift.
- **Don't switch off the power supply**, even if you leave your home for an extended period. The homelift uses your mains power to operate and the backup battery needs to be kept on constant charge.
- **Replace the wall-control batteries annually** (this is normally part of your annual service).
- **Keep the phone numbers in your emergency communication device up to date**: contact your customer service team if they need to be changed.
- **Do not tamper with the homelift**: if you are experiencing any issues with your homelift, please contact your Stannah approved technician for assistance.
- **Give your homelift a regular light clean** (see section on cleaning your homelift).

Cleaning.

Use a clean damp cloth to wipe down the interior and exterior surfaces of the homelift ensuring that there is no excess liquid in the cloth before cleaning. Do not use any abrasive cleaning products or solvents.

7. Maintenance and care

Changing the battery on the remote calling control.

The remote calling control batteries will last about one year with average use. When you press one of the arrow buttons the light around the buttons will indicate whether the battery needs changing.

Lights rotating

Lights on constantly

No light

Batteries ok

Batteries low on power,
change batteries as soon as possible

Batteries have no power

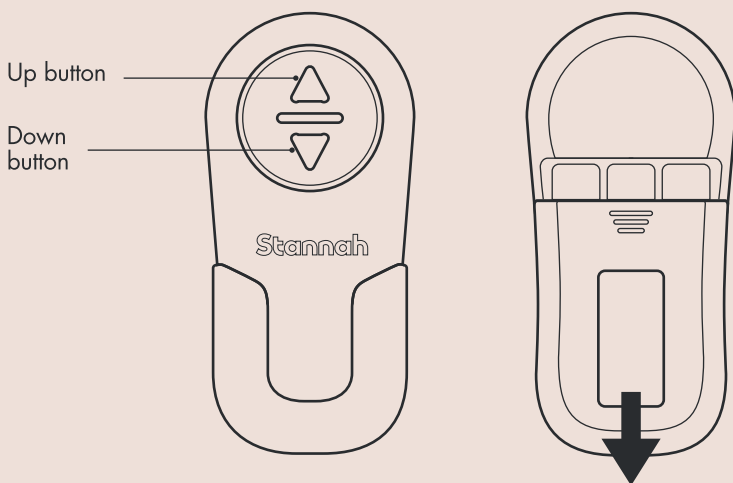

To change the battery, remove screw, slide down and open the battery cover, then insert the new batteries. Each wall control uses three AA batteries.

8. Troubleshooting

- **Homelift not moving:** check to see if the red emergency button has been pressed or if there are any lights on the control panel.
- **Strange noises:** stop using the homelift and contact our customer service team.
- **Door not opening:** see safety procedures.
- **Lights illuminated on the control panel:** follow instruction in the safety feature section 5.

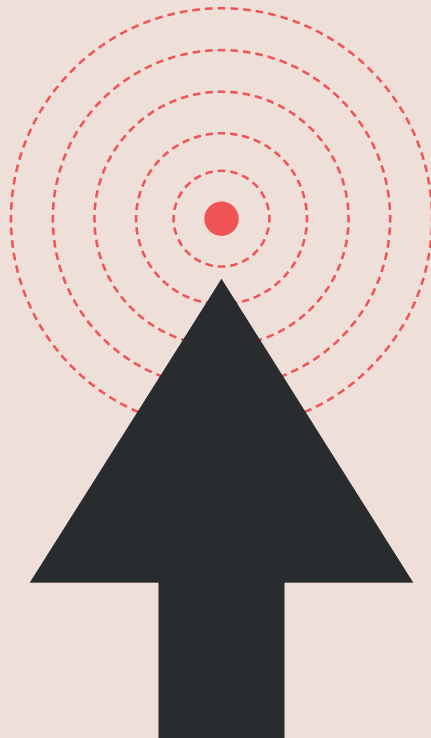

8. Troubleshooting

FAQs

1. Do I need to turn the homelift off when I go on holiday?

No, the homelift has batteries that need to be kept on constant charge.

2. How much does the homelift cost to run?

Each journey costs less than boiling a kettle.

3. Can I use the homelift to carry luggage and other items?

Yes, as long as they weigh less than 250 kg.

4. How often does my homelift need servicing?

Your homelift requires one service per year by a Stannah approved technician. All of our homelifts come with a 2-year warranty.

5. Can I add a seat or accessories?

Yes, please contact our customer service team for details.

6. What do I do if I need to change my upstairs carpet?

Contact your customer service team in advance and we can provide your competent carpet fitter with some instructions.

7. Can I use my homelift in a power cut?

In the event of loss of mains power, there is a battery backup system that ensures you can complete your journey to the ground floor safely. Do not continue to use your homelift until the power has been restored.

9. Technical data and declaration of conformity

Max load limit	250 kg/39 stone/551 lbs
Power supply	230V AC / 8 amps
Noise level (decibel)	Less than 50 db
Maximum speed	0.1 meters per second
Operating temperature	0-40 °C

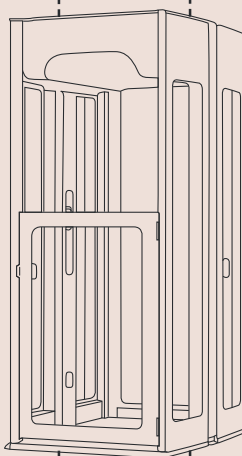



Stannah Homelifts Ltd
Watt Close, East Portway
Andover, Hampshire,
SP10 3SD UK

EC DECLARATION OF CONFORMITY

According to EC directive 2006/42/EC on machinery

We hereby declare that when installed in accordance with Stannah Homelifts Ltd product safety policy and installation instructions the machinery listed below complies and fulfils all the relevant provisions of the following directives.

Machinery Directive 2006/42/EC
Low Voltage Directive 2006/95/EC
EMC Directive 2004/108/EC

Uplifts Homelift Model S2 & S3

Serial Number.....

(completed by approved installer)

The machine has been designed and manufactured in accordance with harmonised European standard: Safety Rules for the Construction and Installation of Lifts - Special Lifts for the transport of persons and goods. Vertical lifting platforms intended for use by persons with impaired mobility BS EN81-41:2010

Technical documentation has been compiled by Steve Leathley (Chief Engineer)

Signed: 

Date: 31st July 2024

Place: Uplifts, Andover

Sam Stannah
Uplifts Managing Director

Being the person empowered to draw up the declaration on behalf of the manufacturer

10. Disposal and recycling



Warning!

Do not dispose of any part of this product or its batteries as part of your normal household waste.

For more information about recycling and disposal of your homelift and its components, please contact our customer service team.

11. Contact us

We're here to help.

If you have any questions or need support, please get in touch with us.

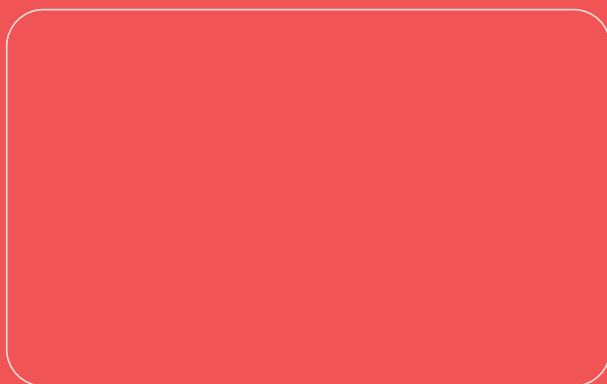

Thank you for choosing our homelift.





Stannah Homelifts Ltd,
Watt Close, East Portway, Andover, Hampshire,
SP10 3SD, United Kingdom
www.stannah.com

User Guide S3
issue UHD-BD-002